



SPARE PARTS CATALOGUE

Electric Range



CONTENTS

ADULTS

| | |
|-----------------------------|----|
| Emicro One | 7 |
| Peugeot Micro | 11 |
| Falcon Micro | 15 |
| Eagle Micro | 19 |
| Condor | 23 |
| Micro Condor II | 27 |
| Micro Explorer | 31 |
| Micro Explorer II | 35 |
| Micro Explorer S | 39 |
| Micro Colibri | 43 |
| Micro E-Bike 16 | 47 |
| Micro Merlin With Handbrake | 51 |
| Micro Merlin Black And Grey | 55 |
| Micro Merlin II | 59 |
| Micro Sparrow XL | 63 |
| Micro Sparrow | 65 |

ADULTS

EMICRO ONE *EM0012*

PARTS

| Article No. | Article |
|-------------|---|
| 5000 | Handlebar Without Grips |
| 5001 | Handles |
| 5002 | Handlebar Clamp |
| 5003 | Extension Tube |
| 5004 | Plastic Linkage Tube |
| 5005 | Extension Tube Quick Release |
| 5006 | Lower Tube |
| 5007 | Lower Clamp |
| 5008 | Steering Head |
| 5010 | Aluminum Spacer Ring (Hic) |
| 5011 | Small Fork |
| 5012 | Small Front Wheel Fender |
| 5013 | Fender Front Wheel Screws |
| 5015 | Spacer Front Wheel |
| 5016 | Axle Front Wheel 150mm |
| 5017 | Shim (Left) |
| 5018 | Shim (Right) |
| 5019 | Push Button Blue |
| 5020 | Bolt For Shims (Left & Right) |
| 5021 | Bolt For Holder Plates (Right) |
| 5022 | Folding Quick Release Kit |
| 5023 | Bolt Left + Right |
| 5024 | Folding Block |
| 5025 | M8 Countersunk Screw Folding Block Left |
| 5026 | M8 Torx Screw |
| 5027 | Kick Stand Set |

| Article No. | Article |
|-------------|---|
| 5042 | Small Deck Main Body V1 For Em0004 |
| 5043 | LED Plastic Cover |
| 5044 | Small Motor V1 (Straight Connectors) |
| 5047 | Griptape |
| 5051 | Rear PU Wheel Incl. (Aluminium Hub With PU) |
| 5052 | Rear Wheel Screw Incl. Washer |
| 5094 | Front Rubber Wheel |
| 5096 | Small Brake Complete Set V2 |
| 5098 | Brake Magnet |
| 5111 | Small Deck Main Body V2 For Em0012 |
| 5182 | Brake Plastic Fixture |
| 5183 | Brake Spring |
| 5184 | Brake Pin |
| 5227 | Screw For Lower Clamp |

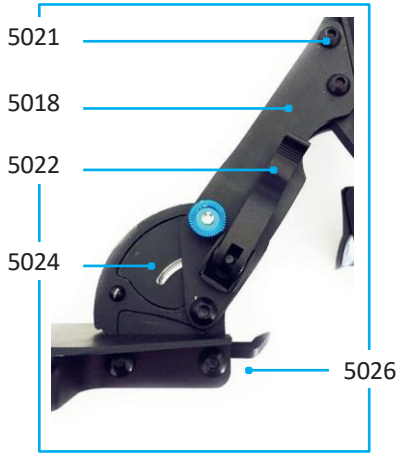
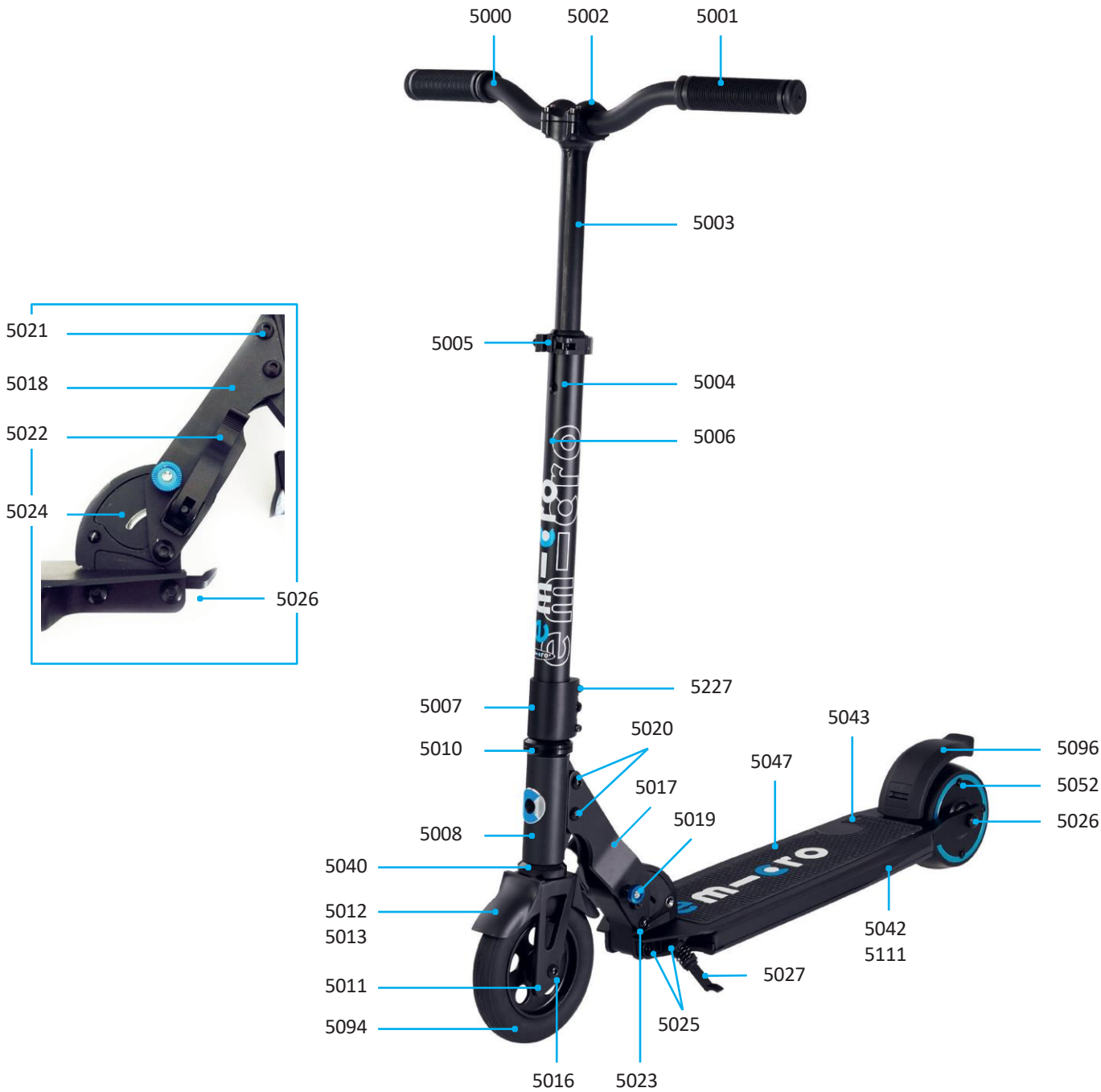

EMICRO
ONE
EM0012

EMICRO ONE *EM0012*

PARTS

| Article No. | Article |
|-------------|-------------------------------------|
| 5026 | Rear Wheel Screw |
| 5028 | Protection Rim |
| 5029 | Cover Screws M4 |
| 5036 | Hexagon Socket Flat Head Screws |
| 5037 | Controller Plastic Cylinder |
| 5038 | Small Cable Groove Protection |
| 5039 | Thermal Pad |
| 5040 | Alu Cover |
| 5055 | Controller V4 (Only Motion Control) |
| 5100 | Small Cable Groove Protection V2 |
| 5102 | Charge Connector V2 |
| 5105 | Small Plastic Cover |
| 5119 | Small O-ring |
| 5125 | Battery |
| 5185 | Brake Fixation Screw |
| 5186 | Rubber Grommet |
| 5234 | M8 Torx Cover Screws |
| Ac5202 | EU Charger |
| Ac5203 | UK Charger |
| Ac5204 | US Charger |
| Ac5205 | AU Charger |

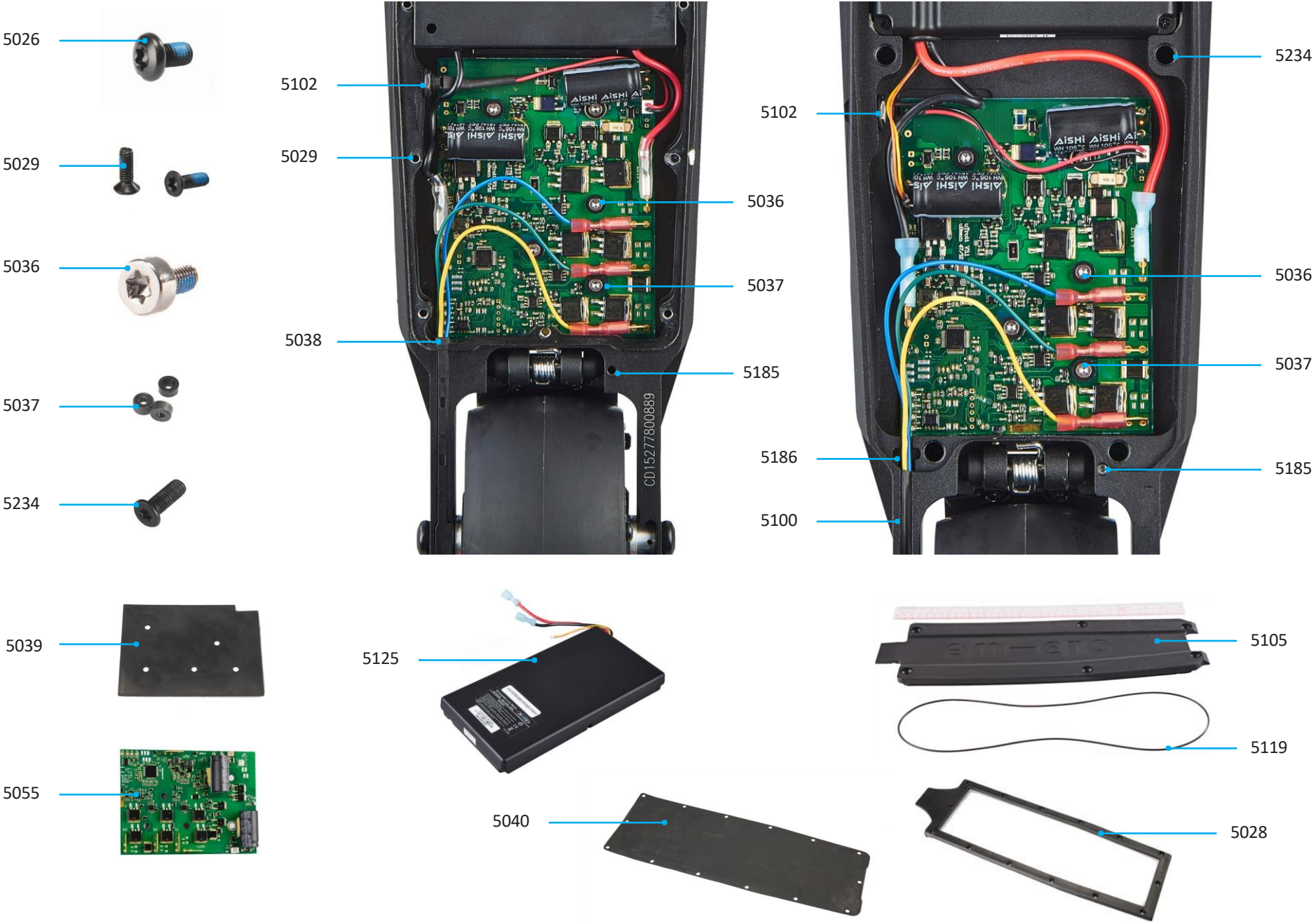

EMICRO
ONE
EM0012

PEUGEOT *EM0006*

| Article No. | Article |
|-------------|--|
| 5015 | Front Spacer |
| 5016 | Front Axle |
| 5019 | Folding Button Blue |
| 5025 | M8 Countersunk Screw (Kickstand Left/Main Cover) |
| 5026 | M8 Torx Screw |
| 5043 | LED Plastic Cover |
| 5051 | Rear PU Wheel Incl. (Aluminium Hub With PU) |
| 5052 | Rear Wheel Screw Incl. Washer |
| 5074 | Handle Left |
| 5078 | Peugeot Fronttube |
| 5086 | Peugeot Folding Complete |
| 5094 | Front Rubber Wheel 145mm |
| 5096 | Brake Complete |
| 5098 | Brake Magnet |
| 5111 | Small Deck Main Body V2 |
| 5114 | Electric Motor With 90° Connectors |
| 5117 | Griptape Peugeot |
| 5179 | Handle Right |
| 5180 | Peugeot Click-in Tonge |
| 5181 | Frontpart Connector Screw |
| 5182 | Brake Plastic Fixture |
| 5183 | Brake Spring |
| 5184 | Brake Pin |



| Article No. | Article |
|-------------|---|
| 5026 | M8 Torx Screw |
| 5036 | Hexagon Socket Flat Head Screws (Controller Screws) |
| 5039 | Thermal Pad |
| 5100 | Small Cable Groove Protection V2 |
| 5102 | Charge Connector V2 |
| 5105 | Small Plastic Cover |
| 5119 | Small O Ring |
| 5126 | Battery V3.2 |
| 5129 | Controller V5 With Plastic Cover |
| 5185 | Brake Fixation Screw |
| 5186 | Motor Cable Rubber Grommet |
| 5234 | M8 Torx Cover Screws |
| Ac5202 | EU Charger |
| Ac5203 | UK Charger |
| Ac5204 | US Charger |
| Ac5205 | AU Charger |

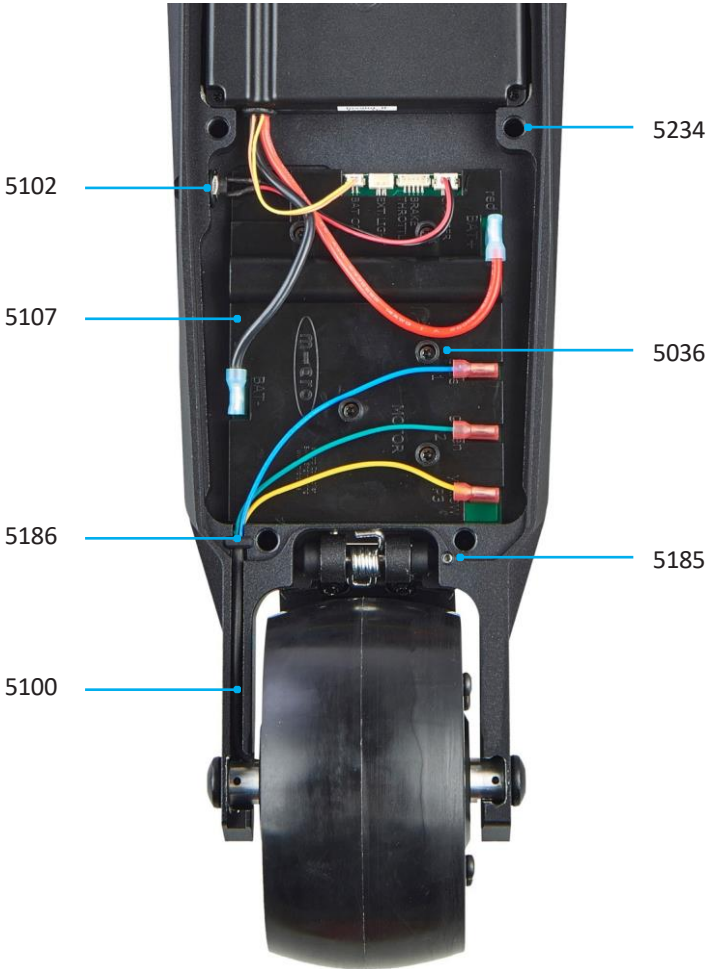
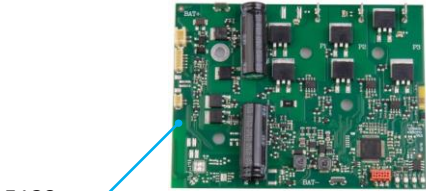
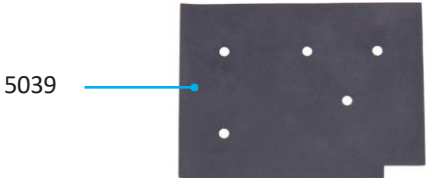

MICRO FALCON EM0008

PARTS

| Article No. | Article |
|-------------|---|
| 5002 | Handlebar Clamp |
| 5003 | Extension Tube |
| 5004 | Plastic Linkage Tube |
| 5005 | Extension Tube Quick Release |
| 5006 | Lower Tube |
| 5007 | Lower Clamp |
| 5010 | Aluminium Spacer Ring (Hic) |
| 5012 | Small Front Wheel Fender |
| 5015 | Spacer Front Wheel |
| 5016 | Axle Front Wheel 150mm |
| 5017 | Shim (Left) |
| 5018 | Shim (Right) |
| 5019 | Push Button Blue |
| 5020 | Bolt For Shims (Left&right) |
| 5022 | Folding Quick Release Kit |
| 5023 | Bolt Left + Right |
| 5025 | M8 Countersunk Screw Folding Block Left |
| 5026 | M8 Torx Screw |
| 5027 | Kick Stand Set |
| 5043 | LED Plastic Cover |
| 5051 | Rear PU Wheel Incl. (Aluminium Hub With PU) |
| 5096 | Small Brake Complete Set V2 |
| 5098 | Brake Magnet |
| 5105 | Small Plastic Cover |
| 5114 | Small Motor |
| 5116 | Small Griptape |

| Article No. | Article |
|-------------|---|
| 5169 | Small Deck Rear Light |
| 5182 | Brake Plastic Fixture |
| 5183 | Brake Spring |
| 5184 | Brake Pin |
| 5196 | Small Deck Main Body |
| 5199 | Spacer Ring To Small Motor (Without Step) |
| 5222 | Throttle Cable Clip |
| 5227 | Screw For Lower Clamp |
| 5230 | Cable Cover For Folding Block |
| 5231 | Screws For Folding Block Cable Cover |
| 5235 | M8 Motor Screw For X3 |
| 5238 | Washer For Motor Screw (To Fit Rearlight) |
| 5240 | Folding Block With Cable Slot |
| 5242 | Rearlight Washer |



MICRO
FALCON
EM0008

MICRO FALCON EM0008

PARTS

| Article No. | Article |
|-------------|---|
| 5027 | Small Kickstand Set |
| 5036 | Hexagon Socket Flat Head Screws (Controller Screws) |
| 5039 | Thermal Pad |
| 5076 | Two-way Throttle Incl All Grips |
| 5091 | Small Frontwheel Fender With Groove |
| 5099 | Small Throttle Cable |
| 5102 | Charge Connector V2 |
| 5105 | Small Plastic Cover |
| 5119 | Small O Ring |
| 5126 | Battery V3.2 |
| 5129 | Controller V5 With Plastic Cover |
| 5169 | Small Deck Rear Light |
| 5228 | Small In-deck Throttle Cable |
| 5230 | Cable Cover For Folding Block |
| 5231 | Screws For Folding Block Cable Cover |
| 5234 | M8 Torx Cover Screws |
| 5235 | M8 Motor Screw For X3 |
| 5240 | Folding Block With Cable Slot |
| 5241 | M8 Cover Screw For Eagle/Condor Rearlight |
| 5242 | Hexagon Socket Flat Head Screws |
| Ac5202 | EU Charger |
| Ac5203 | UK Charger |
| Ac5204 | US Charger |
| Ac5205 | AU Charger |

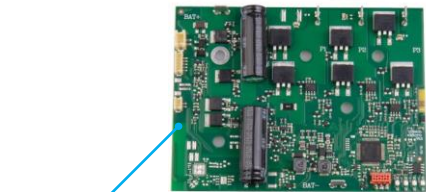
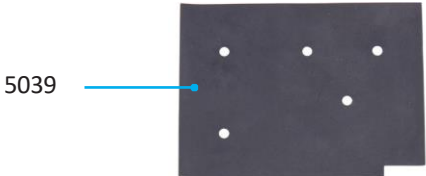
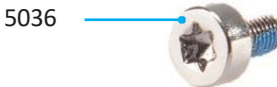

5102

5241



5234



5126



5105



5119



5076



5091



5169



5228



5099

MICRO
FALCON
EM0008

MICRO EAGLE EM0014

PARTS

| Article No. | Article |
|-------------|------------------------------------|
| 5002 | Handlebar Clamp |
| 5004 | Plastic Linkage Tube |
| 5005 | Extension Tube Quick Release |
| 5007 | Lower Clamp |
| 5012 | Small Front Wheel Fender |
| 5013 | Fender Front Wheel Screws |
| 5015 | Spacer Front Wheel |
| 5017 | Shim (Left) |
| 5018 | Shim (Right) |
| 5019 | Push Button Blue |
| 5020 | Bolt For Shims (Left&right) |
| 5022 | Folding Quick Release Kit |
| 5023 | Bolt Left + Right |
| 5043 | Led Plastic Protection |
| 5053 | Allen Key |
| 5076 | Two-way Throttle Incl All Grips |
| 5077 | Steering Head For 200mm Scooter |
| 5081 | Extension Tube For 200mm Scooter |
| 5083 | Steel Tube Cap (HIC) |
| 5087 | Kick Stand Set |
| 5089 | Big Fork With Holes For Frontbrake |
| 5093 | Big Frontwheel Fender |
| 5097 | Large Brake Complete Set |
| 5098 | Brake Magnet |
| 5115 | Large Motor V1 |
| 5116 | Small Griptape |

| Article No. | Article |
|-------------|---|
| 5182 | Brake Rubber Fixture |
| 5183 | Brake Spring |
| 5184 | Brake Pin |
| 5185 | Brake Fixation Screw |
| 5190 | Medium Deck Rear Light |
| 5197 | Medium Deck Main Body V1 |
| 5215 | Large Lower T-tube |
| 5216 | Handlebar With Cable Holes |
| 5217 | Cable Clip |
| 5218 | Front Rubber Wheel 200mm Incl. Brake |
| 5220 | Brake Cable Inc Sleeve |
| 5222 | Throttle Cable Clip |
| 5227 | Screw For Lower Clamp |
| 5230 | Cable Cover For Folding Block |
| 5231 | Screws For Folding Block Cable Cover |
| 5232 | Brake Reflector Set |
| 5234 | Screw Folding Block Left |
| 5235 | M8 Block Motor Screw |
| 5238 | Washer For Motor Screw (To Fit Rearlight) |
| 5240 | Folding Block With Cable Slot |
| 5242 | Rearlight Washer |



MICRO EAGLE EM0014

PARTS

| Article No. | Article |
|-------------|---|
| 5036 | Hexagon Socket Flat Head Screws (Controller Screws) |
| 5039 | Thermal Pad |
| 5076 | Two-way Throttle Incl All Grips |
| 5087 | Large Kickstart Set |
| 5102 | Charge Connector V2 |
| 5104 | Big Throttle Cable |
| 5119 | Small O Ring |
| 5126 | Battery V4 |
| 5129 | Controller V5 With Plastic Cover |
| 5170 | Large Deck Rear Light |
| 5197 | Medium Plastic Cover |
| 5221 | Frontbrake Hand Lever |
| 5228 | Small In-deck Throttle Cable |
| 5232 | Brake Reflector |
| 5234 | M8 Torx Cover Screws |
| 5235 | M8 Motor Screw For X3 |
| 5241 | M8 Cover Screw For Eagle/Condor Rearlight |
| 5242 | Hexagon Socket Flat Head Screws |
| 5250 | Front Wheel Brake |
| Ac5202 | EU Charger |
| Ac5203 | UK Charger |
| Ac5204 | US Charger |
| Ac5205 | AU Charger |

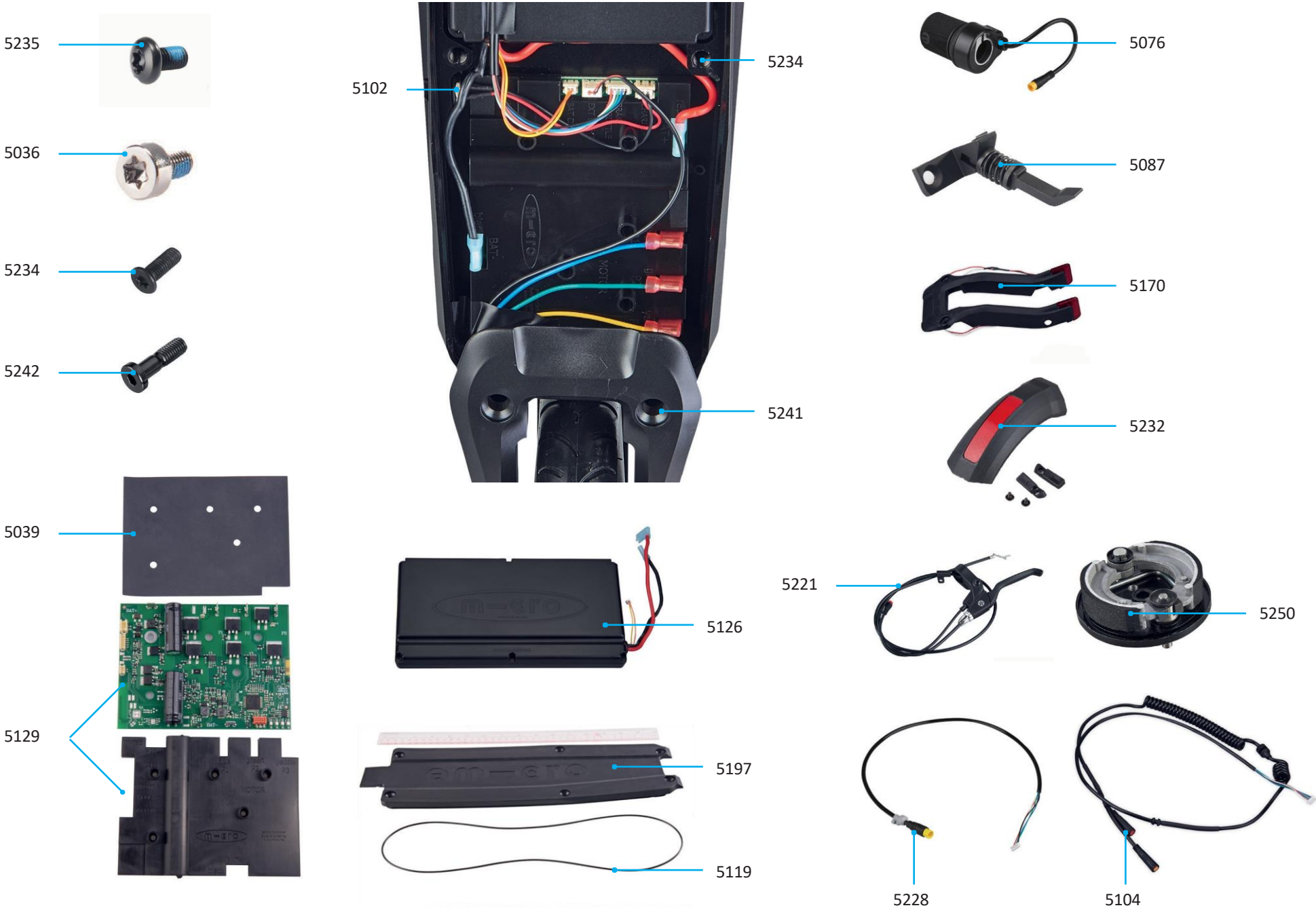

MICRO
EAGLE
EM0014

MICRO CONDOR EM0016

PARTS

| Article No. | Article |
|-------------|------------------------------------|
| 5001 | Handles |
| 5002 | Handlebar Clamp |
| 5004 | Plastic Linkage Tube |
| 5005 | Extension Tube Quick Release |
| 5007 | Lower Clamp |
| 5013 | Fender Front Wheel Screws |
| 5014 | Frontpart Connector Screw |
| 5017 | Shim (Left) |
| 5018 | Shim (Right) |
| 5019 | Push Button Blue |
| 5020 | Bolt For Shims (Left&right) |
| 5022 | Folding Quick Release Kit |
| 5023 | Bolt Left + Right |
| 5087 | Kick Stand Set |
| 5043 | Led Plastic Protection |
| 5077 | Steering Head |
| 5081 | Lower Tube |
| 5082 | Large Lower T-tube |
| 5083 | Steel Tube Cap (HIC) |
| 5089 | Big Fork With Holes For Frontbrake |
| 5093 | Big Frontwheel Fender |
| 5097 | Large Brake Complete Set |
| 5098 | Brake Magnet |
| 5113 | Big Deck Main Body V2 |
| 5115 | Motor V4 |
| 5118 | Large Griptape |
| 5123 | Front Rubber Wheel 200mm |

| Article No. | Article |
|-------------|--------------------------------------|
| 5170 | Large Deck Rear Light |
| 5182 | Brake Rubber Fixture |
| 5183 | Brake Spring |
| 5184 | Brake Pin |
| 5185 | Brake Fixation Screw |
| 5216 | Handlebar With Cable Holes |
| 5217 | Cable Clip |
| 5218 | Front Rubber Wheel 200mm Incl. Brake |
| 5220 | Brake Cable Inc Sleeve |
| 5223 | Front Wheel Axle |
| 5227 | Screw For Lower Clamp |
| 5230 | Cable Cover For Folding Block |
| 5231 | Screws For Folding Block Cable Cover |
| 5232 | Brake Reflector Set |
| 5234 | Screw Folding Block Left |
| 5235 | M8 Block Motor Screw |
| 5238 | Washer For Motor Screw |
| 5240 | Folding Block With Cable Slot |
| 5242 | Rearlight Washer |



MICRO
CONDOR
EM0016

MICRO CONDOR EM0016

PARTS

| Article No. | Article |
|-------------|---|
| 5036 | Hexagon Socket Flat Head Screws (Controller Screws) |
| 5039 | Thermal Pad |
| 5076 | Two-way Throttle Incl All Grips |
| 5087 | Large Kickstart Set |
| 5102 | Charge Connector V2 |
| 5104 | Big Throttle Cable |
| 5112 | Big Deck Main Body V2 |
| 5120 | Big O-ring |
| 5127 | Battery V4 |
| 5129 | Controller V5 With Plastic Cover |
| 5170 | Large Deck Rear Light |
| 5221 | Frontbrake Hand Lever |
| 5229 | Large In-deck Throttle Cable |
| 5232 | Brake Reflector |
| 5234 | M8 Torx Cover Screws |
| 5235 | M8 Motor Screw For X3 |
| 5241 | M8 Cover Screw For Eagle/Condor Rearlight |
| 5242 | Hexagon Socket Flat Head Screws |
| 5250 | Front Wheel Brake |
| Ac5202 | EU Charger |
| Ac5203 | UK Charger |
| Ac5204 | US Charger |
| Ac5205 | AU Charger |

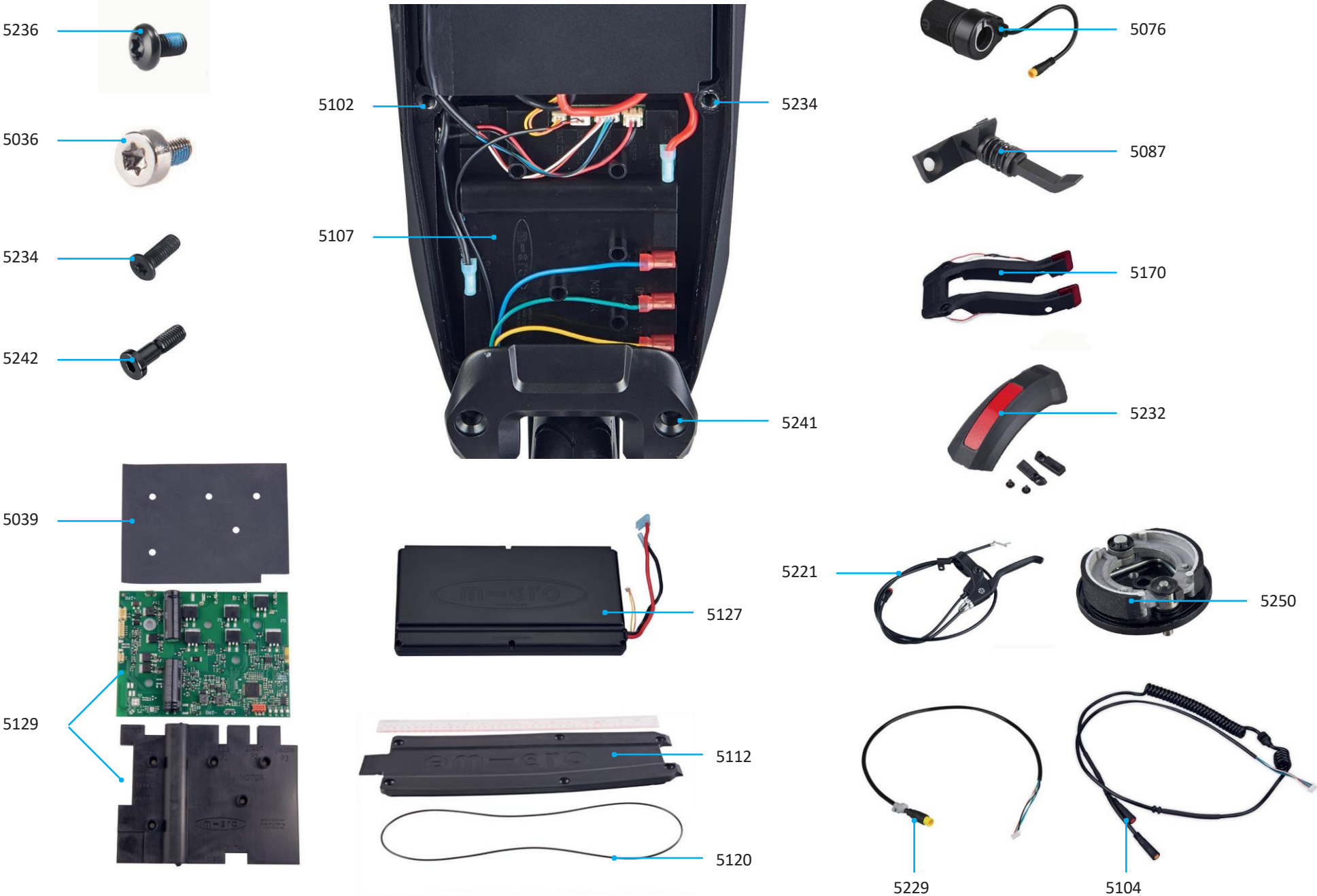

MICRO
CONDOR
EM0016

MICRO CONDOR II: EM0040

PARTS

| Article No. | Article |
|-------------|----------------------------------|
| 5473 | Brake Cable Set |
| 5476 | Front Light Set |
| 5479 | Screw Nut For Folding Machnism |
| 5488 | Side Reflector Set |
| 5497 | Kickstand Set |
| 5826 | Handlebar Set |
| 5827 | Grips Set |
| 5828 | Phone Holder Set |
| 5829 | Throttle |
| 5830 | Brake Lever With Bell |
| 5831 | Full Floding Front Tube Set |
| 5833 | Headset |
| 5834 | Front Fork Set |
| 5835 | Front Fender Set |
| 5838 | Disc Brake |
| 5839 | Front Axle Set |
| 5840 | Front Wheel Set |
| 5841 | Front Tire Set |
| 5842 | Front Reflector Set |
| 5843 | Full Deck Set |
| 5845 | Deck Front Cover & Bluetooth Set |
| 5846 | Grip Tape-front |
| 5847 | Grip Tape-middle |
| 5848 | Grip Tape-rear |
| 5850 | Rear Fender & Light Set |

| Article No. | Article |
|-------------|-------------|
| 5852 | Motor |
| 5853 | Rear Tire |
| 5854 | Battery Set |
| Sbox370 | Color Box |
| Sbox371 | Master Box |

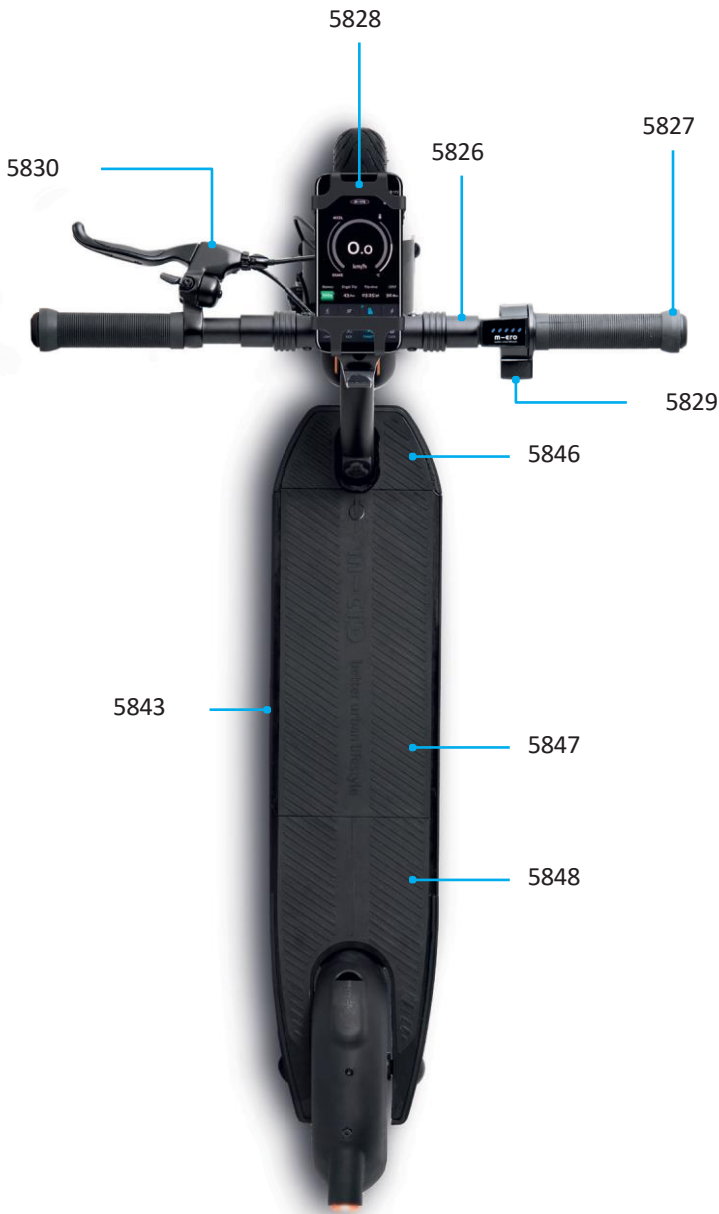

MICRO CONDOR II
EM0040

MICRO CONDOR II: EM0040

PARTS

| Article No. | Article |
|-------------|---------------------------------|
| 5447 | UK Charger |
| 5448 | AU Charger |
| 5449 | US Charger |
| 5479 | Screw Nut For Folding Mechanism |
| 5825 | Full Handlebar Set |
| 5832 | Full Front Wheel Set |
| 5836 | Full Disc Brake Set |

| Article No. | Article |
|-------------|-------------------|
| 5837 | Disc Brake Pads |
| 5844 | Charger Cover Set |
| 5849 | License Plate |
| 5851 | Controller |
| 5855 | EU Charger |
| 5856 | Battery Locker |
| 5857 | Main Cable |



MICRO CONDOR II
EM0040

MICRO EXPLORER:
EM0036 / EM0037 / EM0038 / EM0039 / EM0051

| Article No. | Article |
|-------------|---------------------------------------|
| 5703 | Twist Throttle Set |
| 5704 | Hand Brake Set |
| 5705 | Handles |
| 5707 | Upper Clamp Set |
| 5709 | Lower Clamp Set (include Front Light) |
| 5710 | Tube Set Inside |
| 5714 | Neck Tube Set |
| 5718 | Rear Ears Set |
| 5719 | Rear Fender Set (Include Rear Light) |
| 5720 | Motor With Washers And Nuts |
| 5721 | Rear Wheel With Drum Brake Set |
| 5722 | Front Ears Set |
| 5820 | Deck Front And Rear Cover Set |
| 5726 | Front Light |
| 5727 | Rear Light |
| 5728 | Rear Reflectors |
| 5730 | Side Cover For Deck |
| 5819 | Wires Holder And Lock Ring |
| 5732 | Front Fork Plastic Cover |
| 5084 | Micro Logo |
| 5735 | Black Front Suspension Cover |

| Article No. | Article |
|-------------|---|
| 5736 | Griptape |
| 5702 | Display With Screws (EU) |
| 5806 | Display Explorer DE (Max Speed 22km/H, No Secret Code) |
| 5807 | Display Explorer CH (Max Speed 22km/H, With Secret Code) |
| 5808 | Display Explorer EU With Secret Code (Max Speed 25km/H, With Secret Code) |
| 5865 | Display Explorer FR (Max Speed 25km/H, No Secret Code) |
| DP0040 | Micro Explorer POS Foldable Carton Display |
| Sbox362 | Masterbox Explorer |



MICRO
EXPLORER

MICRO EXPLORER: EM0036

| Article No. | Article |
|-------------|--|
| 5700 | T-pipe Control Set Complete |
| 5701 | T-pipe Set (Mechanical) |
| 5706 | Maincable Set |
| 5708 | Aluminum Tube Set |
| 5712 | Front Fork Set |
| 5715 | Conroller Set |
| 5822 | Controller Set CH (22km/H, Unlocked Speed) |
| 5716 | Full Rear Fork Set |
| 5729 | Battery (LG Cells) |
| 5821 | Battery (Lishen Cells) |

MICRO MERCEDES

| Article No. | Article |
|-------------|--------------------|
| 5734 | Mercedes Star |
| 5737 | Mercedes Grip Tape |
| 5541 | EU Charger |
| 5253 | UK Charger |
| 5257 | AU Charger |
| 5255 | US Charger |
| 5864 | Kickstand |

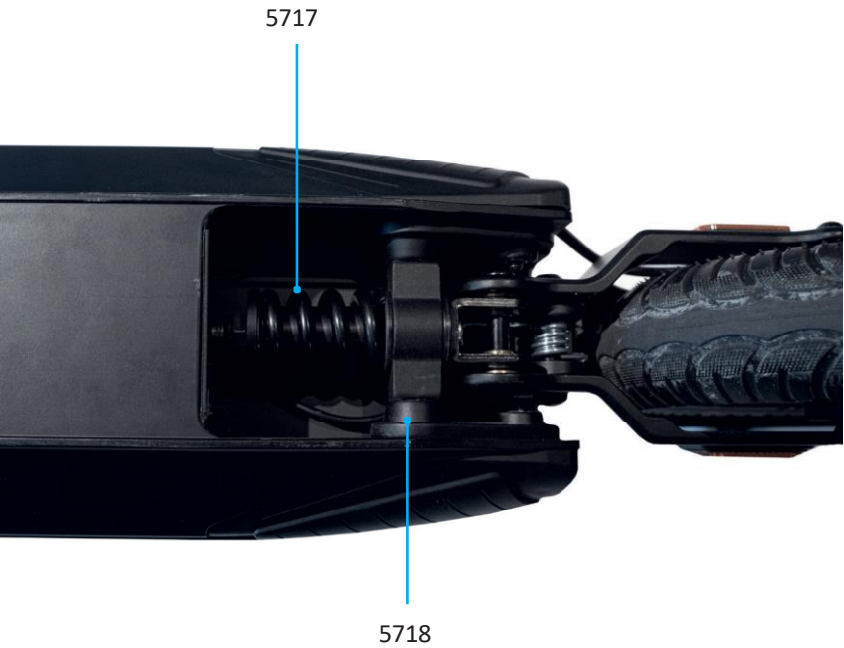

MICRO EXPLORER II: EM0074 / EM0081

PARTS

| Article No. | Article |
|-------------|---|
| 5703 | Twist Throttle Set |
| 5704 | Hand Brake Set |
| 5705 | Handles |
| 5884 | Upper Clamp Set |
| 5709 | Lower Clamp Set(include Front Light) |
| 5710 | Tube Set Inside |
| 5886 | Neck Tube Set |
| 5718 | Rear Ears Set |
| 5719 | Rear Fender Set (Include Rear Light) |
| 5720 | Motor With Washers And Nuts |
| 5721 | Rear Wheel With Drum Brake Set |
| 5887 | Front Ears Set |
| 5820 | Deck Front And Rear Cover Set |
| 5726 | Front Light |
| 5727 | Rear Light |
| 5728 | Rear Reflectors |
| 5730 | Deck Side Front And Rear Covers With Screws |
| 5819 | Wires Holder And Lock Ring |
| 5731 | Deck |
| 5894 | Front Fork Plastic Cover |
| 5084 | Micro Logo |
| 5735 | Black Front Suspension Cover |
| 5652 | Plastic Linkage Tube |
| 5651 | Handle End Caps |

| Article No. | Article |
|-------------|---|
| 5736 | Griptape |
| 5882 | Display With Screws |
| 5895 | Controller EU (25km/H *Cannot Unlock The Speed) |
| 5896 | Controller EU (25km/H *Can Unlock The Speed Till 30km/H) |
| 5897 | Controller DE (22km/H *Cannot Unlock The Speed) |
| 5898 | Controller DE (22km/H *Can Unlock The Speed Till 30 Km/H) |
| DP0040 | Micro Explorer POS Foldable Carton Display |



MICRO
EXPLORER II
EM0074 / EM0081

MICRO EXPLORER II: EM0074 / EM0081

PARTS

| Article No. | Article |
|-------------|-----------------------------|
| 5878 | T-pipe Control Set Complete |
| 5879 | T-pipe Set (Mechanical) |
| 5883 | Maincable Set |
| 5708 | Aluminum Tube Set |
| 5885 | Front Fork Set |
| 5716 | Full Rear Fork Set |
| 5821 | Battery (Lishen Cells) |
| 5964 | License Plate |

| Article No. | Article |
|-------------|------------|
| 5541 | EU Charger |
| 5253 | UK Charger |
| 5257 | AU Charger |
| 5255 | US Charger |
| 5864 | Kickstand |

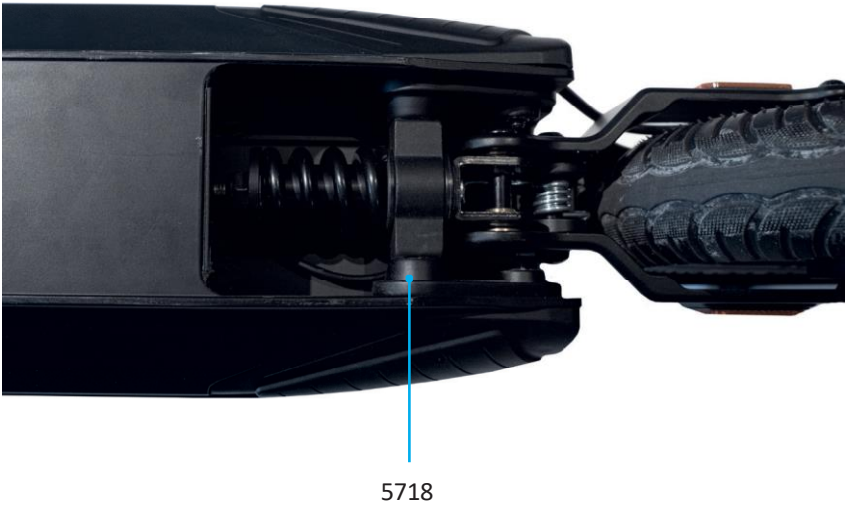

MICRO
EXPLORER II
EM0074 / EM0081

MICRO EXPLORER S: EM0072 / EM0076

PARTS

| Article No. | Article |
|-------------|---|
| 5703 | Twist Throttle Set |
| 5704 | Hand Brake Set |
| 5705 | Handles |
| 5884 | Upper Clamp Set |
| 5709 | Lower Clamp Set(include Front Light) |
| 5710 | Tube Set Inside |
| 5948 | Neck Tube Set |
| 5718 | Rear Ears Set |
| 5719 | Rear Fender Set (Include Rear Light) |
| 5949 | Motor With Washers And Nuts |
| 5721 | Rear Wheel With Drum Brake Set |
| 5950 | Front Ears Set |
| 5820 | Deck Front And Rear Cover Set |
| 5726 | Front Light |
| 5727 | Rear Light |
| 5728 | Rear Reflectors |
| 5951 | Deck Side Front And Rear Covers With Screws |
| 5946 | Wires Holder And Lock Ring |
| 5894 | Front Fork Plastic Cover |
| 5084 | Micro Logo |
| 5735 | Black Front Suspension Cover |
| 5651 | Handle End Caps |
| 5652 | Plastic Linkage Tube |

| Article No. | Article |
|-------------|---|
| 5736 | Griptape |
| 5908 | Display With Screws |
| 5953 | Controller EU (25km/H *Cannot Unlock The Speed) |
| 5954 | Controller EU (25km/H *Can Unlock The Speed Till 30km/H) |
| 5955 | Controller DE (22km/H *Cannot Unlock The Speed) |
| 5956 | Controller DE (22km/H *Can Unlock The Speed Till 30 Km/H) |
| Sbox530 | Masterbox Explorer |

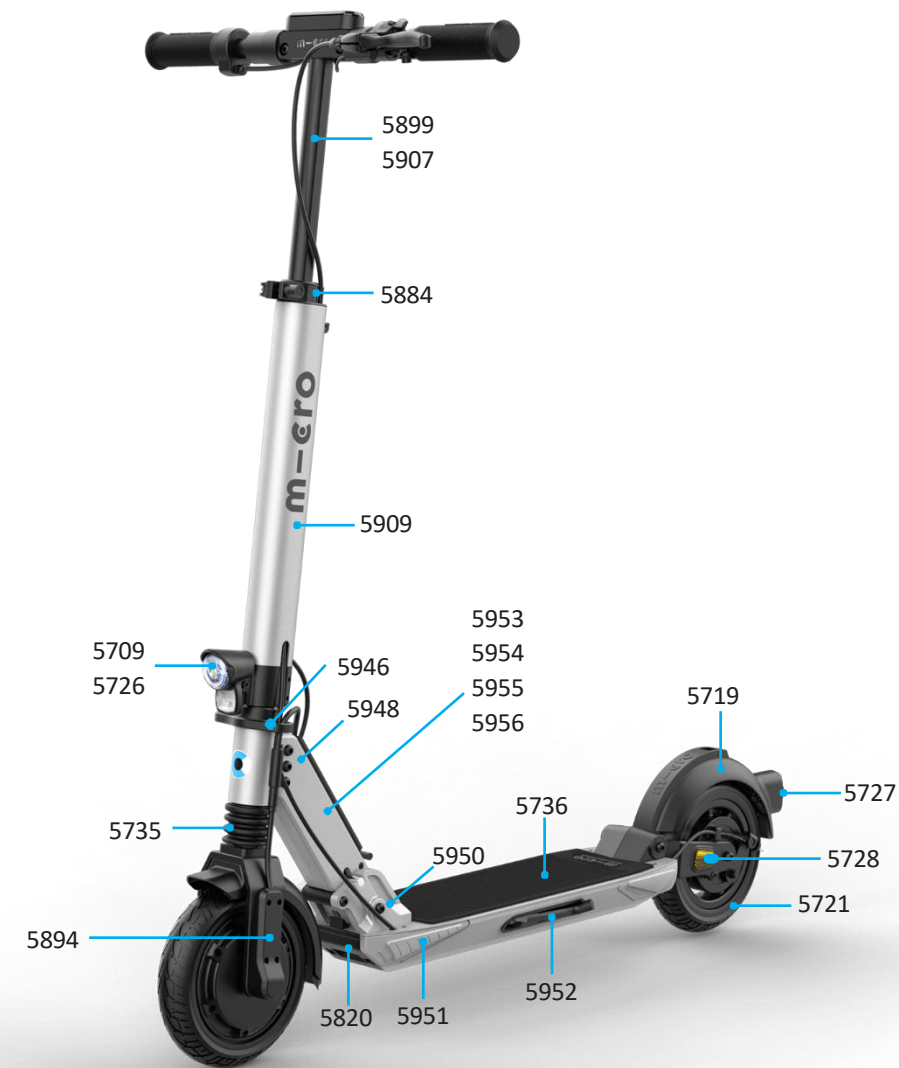
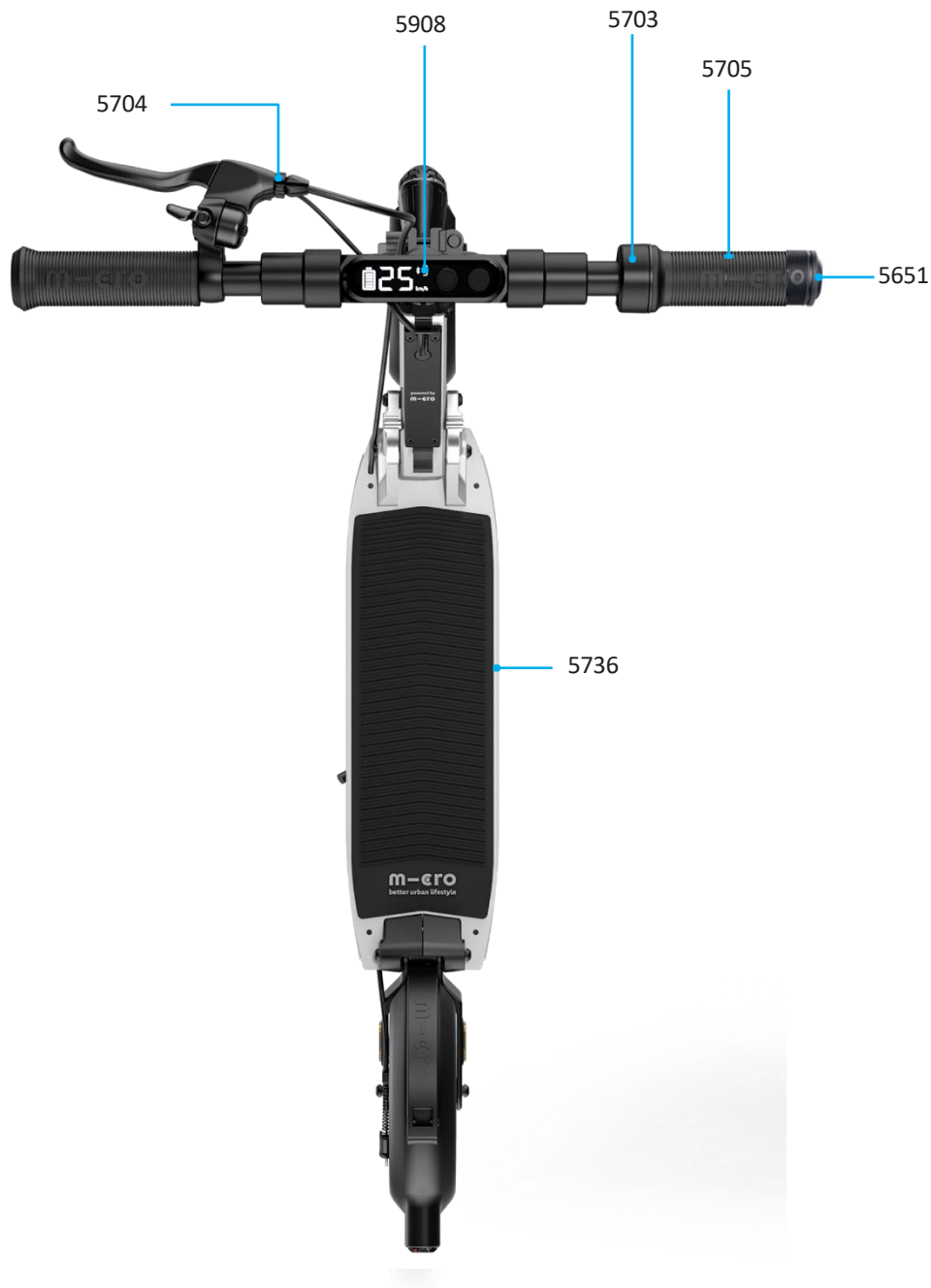

MICRO
EXPLORER S
EM0072 / EM0076

MICRO EXPLORER S: EM0072 / EM0076

PARTS

| Article No. | Article |
|-------------|-----------------------------|
| 5899 | T-pipe Control Set Complete |
| 5907 | T-pipe Set (Mechanical) |
| 5883 | Maincable Set |
| 5909 | Aluminum Tube Set |
| 5947 | Front Fork Set |
| 5716 | Full Rear Fork Set |
| 5957 | Battery |
| 5964 | License Plate |

| Article No. | Article |
|-------------|------------|
| 5541 | EU Charger |
| 5253 | UK Charger |
| 5257 | AU Charger |
| 5255 | US Charger |
| 5952 | Kickstand |

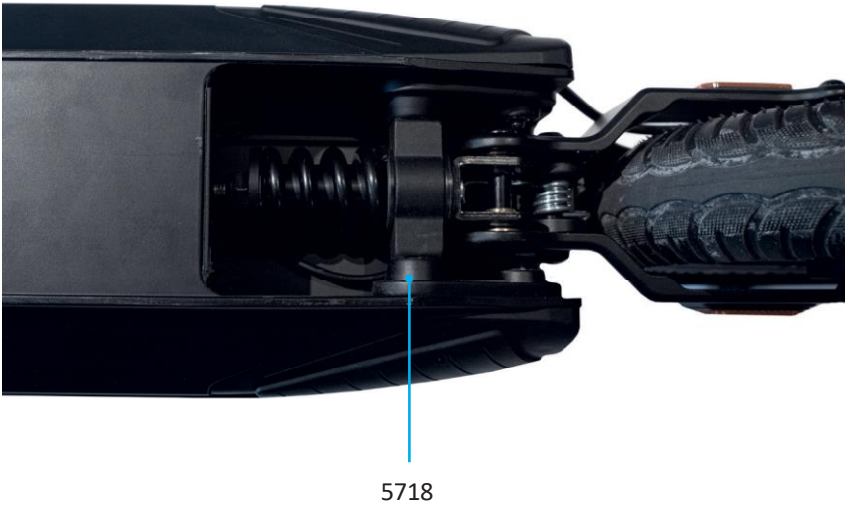
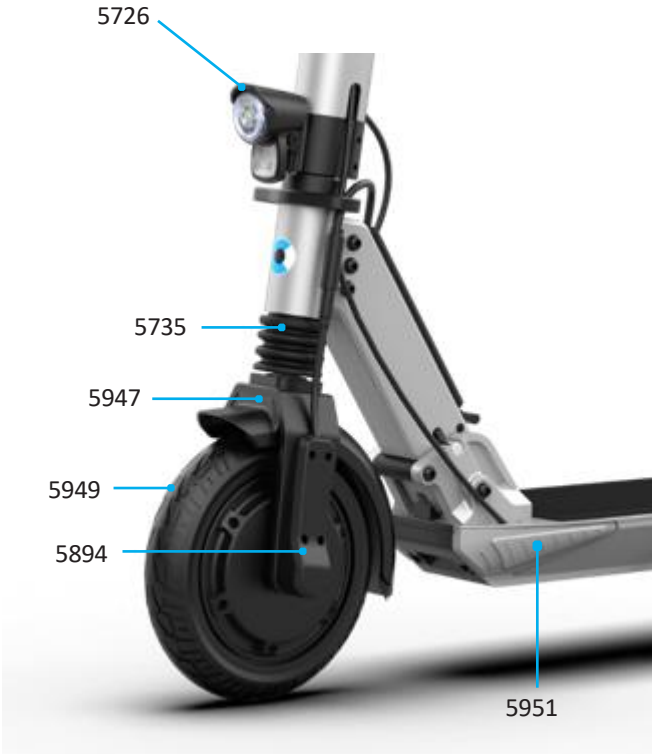

MICRO
EXPLORER S
EM0072 / EM0076

MICRO COLIBRI EM0018

PARTS

| Article No. | Article |
|-------------|-------------------------------------|
| 5463 | Brake Lever With Bell |
| 5476 | Front Light Incl. Holder & Screws |
| 5477 | Nut, Screw |
| 5480 | Upper Cap, Lower Junk Ring, Bearing |
| 5481 | Front Fork Set |
| 5482 | Front Fender Set |
| 5483 | Front Wheel Set |
| 5488 | Side Reflector |
| 5494 | Motor Nut Protective Cap |
| 5497 | Kickstand Set |
| 5498 | Charger Cover Set |
| 5505 | Front Axle |
| 5506 | Motor Nuts |
| 5525 | Throttle |
| 5526 | Stem Lower Cap, Stem Upper Cap |
| 5527 | Front Tube |
| 5528 | Deck+ Griptape |
| 5529 | Grip Tape |

| Article No. | Article |
|-------------|--|
| 5530 | Rear Fork Set |
| 5600 | Phone Holder Fixed Plate |
| 5601 | Phone Holder |
| 5603 | Front Tube With Stickers / Folding Machnism & Main Cable |
| 5880 | Wheel Coat |
| Sbox324 | Color Box |
| Sbox325 | Master Box |



MICROC OLIBRI
EM0018

MICRO COLIBRI *EM0018*

| Article No. | Article |
|-------------|--|
| 5523 | Handlebar With Thumb Throttle |
| 5524 | Grip |
| 5462 | Throttle |
| 5464 | Front Reflector |
| 5485 | Deck |
| 5489 | Griptape |
| 5492 | Rear Fork Set |
| 5470 | Front Tube + Folding + Cables |
| 5471 | Cable Plug |
| 5474 | Main Cable To Front Light & Neck Cable |
| 5475 | Adapter Cable From Neck To Battery |
| 5479 | Hexgon Screw Nut |
| 5484 | Full Front Fork + Wheel + Fender |
| 5493 | Rear Brake Incl. Hall Sensor Set + Light |
| 5499 | EU Charger |
| 5500 | UK Charger |
| 5501 | US Charger |
| 5502 | AU Charger |
| 5522 | Full Handlebar Set |

MICRO BMW *EM0031*

| Article No. | Article |
|-------------|--|
| 5459 | Full Handlebar Set |
| 5460 | Handlebar With Thumb Throttle |
| 5461 | Grip |
| 5462 | Throttle |
| 5465 | Stem Completed Incl. Folding Hook & Screws |
| 5470 | Front Tube With Stickers / Folding Machnism & Main Cable |
| 5485 | Completed Deck With Grip Tape, W/O Side Reflectors |
| 5489 | Grip Tape |
| 5492 | Rear Fork |
| 5432 | EU Charger BMW |

5464



5471



5474



5475



5484



5493



5495



5490



5491



5496



5499



5522



5523



MICRO
COLIBRI
EM0018

MICRO E-BIKE 16“ EB0002

PARTS

| Article No. | Article |
|-------------|--|
| 5626 | Battery(lion) 4000mah Power Bank Type, Removable |
| 7042 | Motor (Real Wheel Assembly) Complete With Tire And Inner Tube) |
| 7043 | Sensor |
| 7044 | Brake Lever Left/Right |
| 7045 | Front Reflector (White) |
| 7046 | Rear Reflector (Red) |
| 7047 | Handle Grip (Set 2pcs) |
| 7048 | Battery Mount Support |
| 7049 | Handle Bar With Grips |
| 7052 | Front Mudguard |
| 7053 | Rear Mudguard |
| 7054 | Saddle |
| 7055 | Seat Tube |
| 7056 | Front Wheel Complete |
| 7057 | 16 Inch Tire (Rear/Front) |
| 7058 | 16inch Inner Tube (Rear/Front) |
| 7059 | Pedals Set (2pcs) |
| 7060 | Wheels Reflectors |
| 7061 | Brake Pads (2pcs) |
| 7063 | Chain |
| 7064 | Quick Release Clamp Saddle Steam |

| Article No. | Article |
|-------------|----------------------------------|
| 7065 | Quick Release Clamp Handlebar |
| 7066 | Freewheel (Multiple 6-speed |
| 7069 | Bell |
| 7070 | Kickstand |
| 7071 | Rubber Gasket Cables |
| 7073 | Spiral Binding |
| 7074 | Complete Front Brake With Cables |
| 7075 | Complete Rear Brake With Cables |
| 7076 | Head Set |
| 7087 | Shifting Cable |
| 7088 | New Controller |
| 7089 | Matt Front Fender |
| 7090 | Matt Rear Fender |



MICRO E-BIKE
16“
EB0002

MICRO E-BIKE 16“ EB0002

PARTS

| Article No. | Article |
|-------------|------------------------------|
| 7040 | Controller |
| 7050 | Upper Tube |
| 7051 | Lower Tube With Foldin Joint |
| 7062 | Chain Wheel |
| 7067 | Frame Latch Plastic Lock |
| 7072 | EU Charger |
| 7080 | UK Charger |
| 7106 | Gear Shifter |
| 7107 | Twist Shifter For Handle |



MICRO E-BIKE
16"
EB000

MICRO MERLIN WITH HANDBRAKE:
EM0035/ EM0049 / EM0055 / EM0056

| Article No. | Article |
|-------------|----------------------------------|
| 5084 | Micro Logo |
| 5308 | Handgrips |
| 5531 | Handrake Set |
| 5324 | Left And Right Thumb Trottle |
| 5344/5344c | Clamp With Hook And Cable Holder |
| 5536 | Display With Cover And Screws |
| 5386 | T-tube |
| 5387 | Lower Clamp With Screws |
| 5305 | Rubber Shock Cover |
| 5514 | Front Fender With Screws |
| 5511/5511c | Front Fork Cover With Reflector |
| 5331 | Motor With Washers And Nuts |
| 5509/5509c | Neck Tube Set |
| 5515 | Front And Rear Battery Cover |
| 5508 | Rear Ears Set With Gaskets |
| 5543 | Rear Fork |
| 5550 | Battery |
| 5350 | Rear Light Wire |
| 5532 | Rear Wheel With Drum Brake |
| 5534 | Rear Wheel Axle |
| 5538 | Rear Fender |
| 5540 | Side Reflector Rear Fork |
| 5537 | Rubber Support Reflector |
| 5346 | Spring And Bolt For T-Bar |
| 5913 | Cable Guider Out Of Controller |
| 5458 | Griptape |
| 5647 | Handle End Caps |

MICRO MERLIN WITHOUT
HANDBRAKE: EM0019

| Article No. | Article |
|-------------|-----------------------------|
| 5303 | Rear Fender With Rear Light |
| 5314 | Controller |
| 5315 | Rear Fork Set |
| 5316 | T-pipe Set |
| 5329 | Rear Wheel |



MICRO MERLIN WITH HANDBRAKE:
EM0035/ EM0049 / EM0055 / EM0056

| Article No. | Article |
|-------------|---|
| 5539 | Controller (25km/H Limited, Max. 30km/H) |
| 5547 | Controller (France Version: 25km/H Limited) |
| 5441 | Controller (25km/H Limited, Max. 30km/H With Motor Brake) |
| 5873 | Controller (22km/H Limited, Max. 30km/H) |
| 5541 | Charger EU Plug |
| 5253 | Charger UK Plug |
| 5255 | Charger US Plug |
| 5257 | Charger AU Plug |
| 5542 | Rear Fender Set Complete With Shock Absorber |
| 5513/5513c | Front Ears Left And Right |
| 5389/5389c | Front Suspension |
| 5456 | Left And Right Plastic Handlebar |
| 5533 | T-pipe Set Complete |
| 5334 | Wires Holder |

5541
5253
5255
5257



5542



5389
5389C



5334



5539
5441
5547
5873



5513
5513C



5456



5533



MICRO MERLIN: EM0087

PARTS

| Article No. | Article |
|-------------|--|
| 5084 | Micro Logo |
| 5308 | Handgrips |
| 5647 | Endcaps Handgrips |
| 5531 | Handbrake With Cables |
| 5324 | Left And Right Thumb Throttle With Screws |
| 5344c | Clamp With Hook And Cable Holder |
| 5536 | Display With Cover And Screws |
| 5903 | T-tube |
| 5387 | Lower Clamp With Screws |
| 5735 | Rubber Shock Cover Black |
| 5514 | Front Fender With Screws |
| 5511c | Front Fork Cover With Reflector And Screws |
| 5331 | Motor With Washers And Nuts |
| 5904 | Neck Tube With Axles And Screws |
| 5515 | Front And Rear Battery Cover Set |
| 5548 | Rear Ears Set With Gaskets |
| 5543 | Rear Fork |
| 5914 | Rear Fork Set Complete |
| 5550 | Battery |
| 5346 | Spring And Bolt For T-Bar |
| 5350 | Rear Light Wire |

| Article No. | Article |
|-------------|--------------------------------|
| 5532 | Rear Wheel With Drum Brake Set |
| 5534 | Rear Wheel Axle |
| 5538 | Rear Fender With Screws |
| 5540 | Side Reflector Rear Fork |
| 5537 | Rubber Support Reflector |
| 5913 | Cable Guider Out Of Controller |
| 5458 | Griptape |

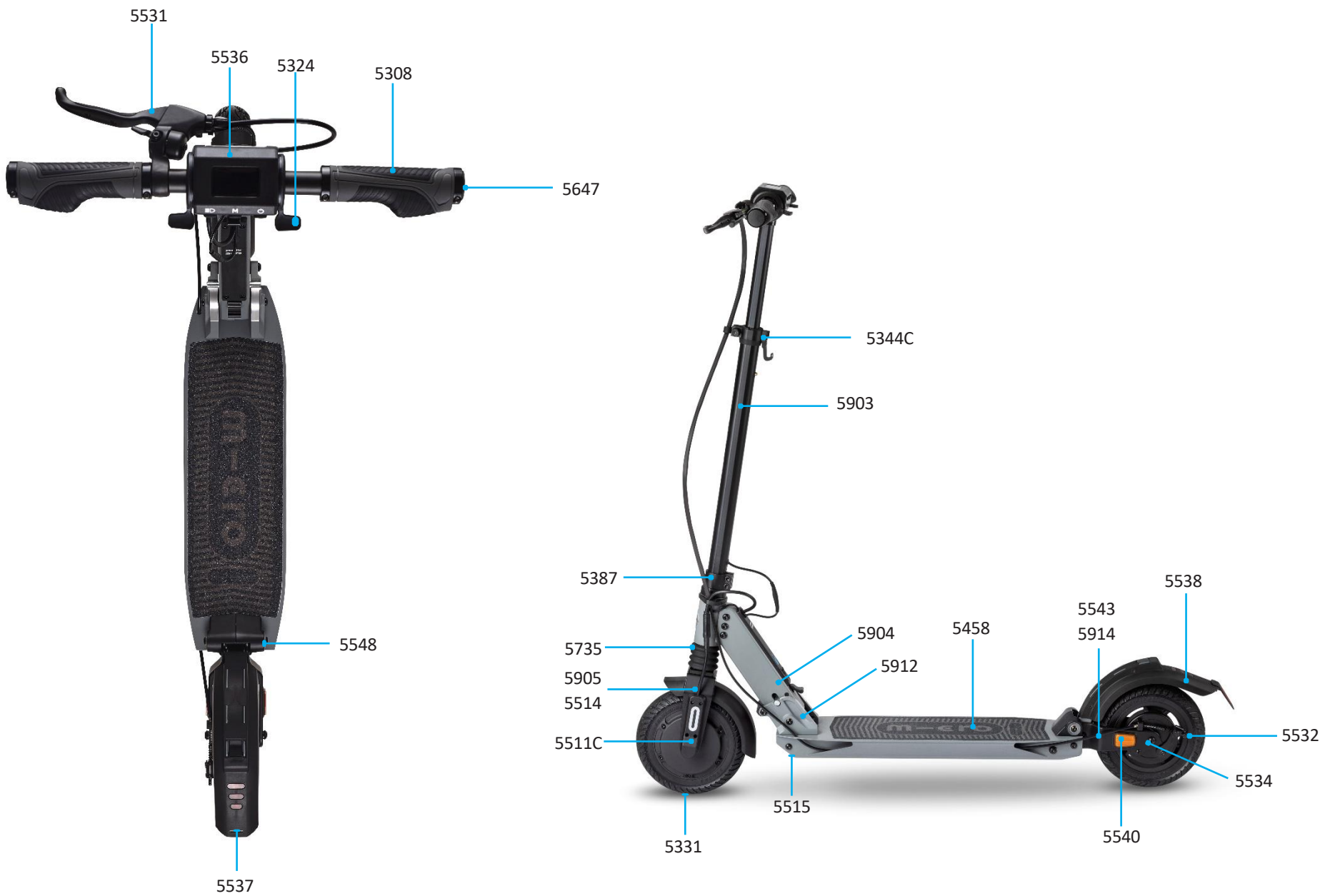

MICRO MERLIN
EM0087

MICRO MERLIN WITH HANDBRAKE: EM0087

PARTS

| Article No. | Article |
|-------------|--|
| 5541 | EU Charger |
| 5253 | UK Charger |
| 5255 | US Charger |
| 5257 | AU Charger |
| 5539 | Controller Set (25km/H Limited, Max 30km/H) |
| 5547 | Controller Set FR (25km/H Limited) |
| 5441 | Controller Set (25km/H Limited, Max 30km/H With Motor Brake) |
| 5873 | Controller Set (22km/H Limited, Max 30km/H) |
| 5533 | T-pipe Set Complete |
| 5456 | Left And Right Plastic Handlebar Folding With Screws |
| 5912 | Front Ears Left And Right |
| 5905 | Front Suspension Set |
| 5334 | Wires Holder |

5541
5253
5255
5257



5914



5533



5334



5539
5547
5441
5873



5912



5905



5456



MICRO MERLIN II: EM0086 / EM0092

PARTS

| Article No. | Article |
|-------------|--|
| 5084 | Micro Logo |
| 5308 | Handgrips |
| 5647 | Endcaps Handgrips |
| 5704 | Handbrake With Cables |
| 5965 | Left And Right Thumb Throttle With Screws |
| 5344c | Clamp With Hook And Cable Holder |
| 5206 | Display With Cover And Screws |
| 5694 | Plastic Linkage Tube |
| 5207 | T-Tube |
| 5387 | Lower Clamp With Screws |
| 5735 | Rubber Shock Cover Black |
| 5514 | Front Fender With Screws |
| 5511c | Front Fork Cover With Reflector And Screws |
| 5720 | Motor With Washers And Nuts |
| 5904 | Neck Tube With Axles And Screws |
| 5820 | Deck Front And Rear Cover Set |
| 5548 | Rear Ears Set With Gaskets |
| 5543 | Rear Fork |
| 5914 | Rear Fork Set Complete |
| 5346 | Spring And Bolt For T-Bar |
| 5821 | Battery |
| 5350 | Rear Light Wire |

| Article No. | Article |
|-------------|--------------------------------|
| 5650 | Main Cable |
| 5721 | Rear Wheel With Drum Brake Set |
| 5534 | Rear Wheel Axle |
| 5538 | Rear Fender With Screws |
| 5540 | Side Reflector Rear Fork |
| 5537 | Rubber Support Reflector |
| 5864 | Kickstand |
| 5913 | Cable Guider Out Of Controller |
| 5458 | Griptape |

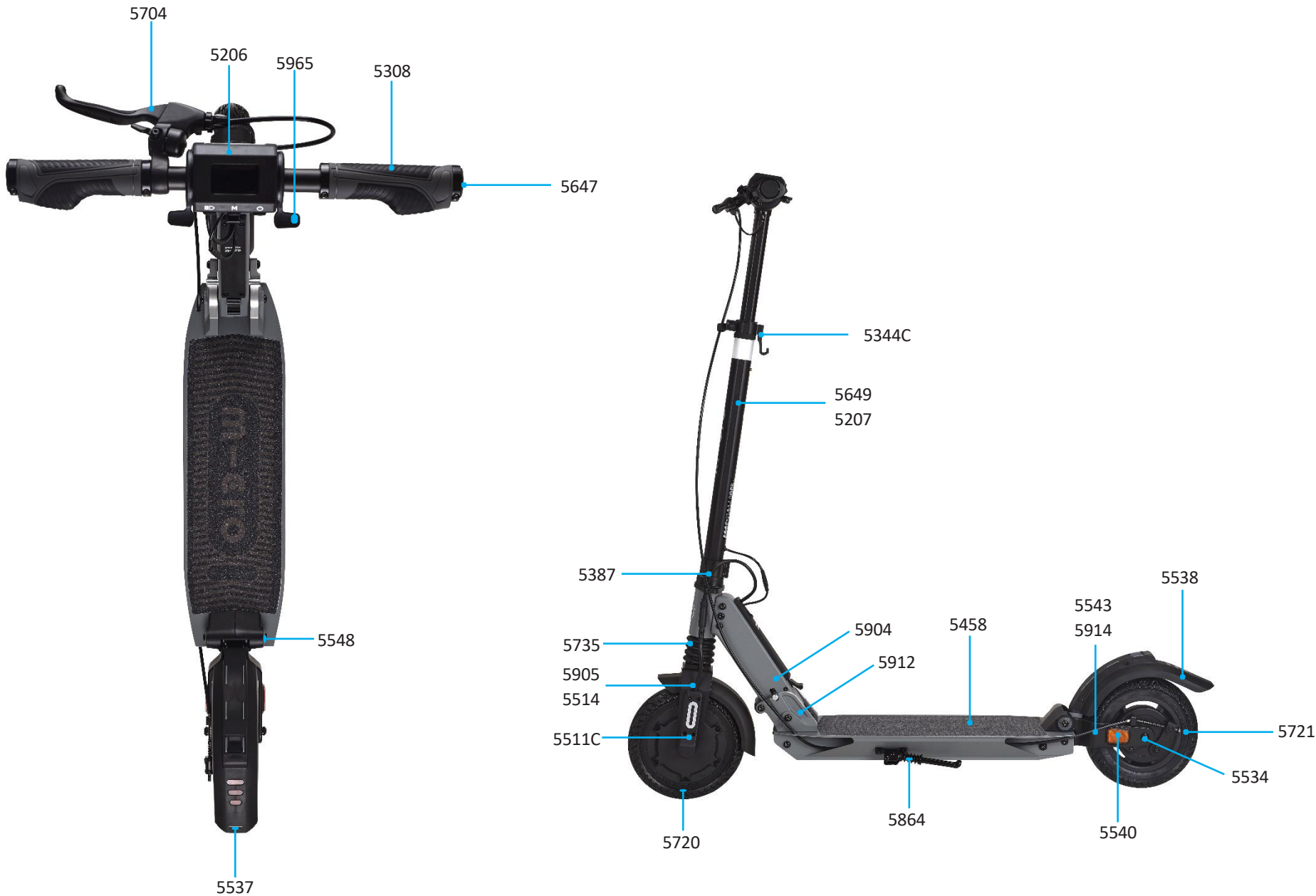

MICRO MERLIN
EM0092 / EM0086

MICRO MERLIN WITH HANDBRAKE: EM0086 / EM0092

PARTS

| Article No. | Article |
|-------------|---|
| 5541 | EU Charger |
| 5253 | UK Charger |
| 5255 | US Charger |
| 5257 | AU Charger |
| 5208 | Controller Set EU (25km/H Can Not Unlock The Speed) |
| 5209 | Controller Set EU (25km/H Can Unlock The Speed Till 30km/H) |
| 5210 | Controller Set DE (22km/H Cannot Unlock The Speed) |
| 5211 | Controller Set DE (22km/H Can Unlock The Speed Till 30km/H) |
| 5648 | T-pipe Set Mechanical |
| 5201 | T-pipe Set Complete |
| 5456 | Left And Right Plastic Handlebar Folding With Screws |
| 5912 | Front Ears Left And Right |
| 5905 | Front Suspension Set |
| 5334 | Wires Holder |

5541
5253
5255
5257



5914



5648



5201



5334



5208
5209
5210
5211



5912



5905



5456



MICRO SPARROW XL EM0017

PARTS

| Article No. | Article |
|-------------|---|
| 5412 | Handlebar With Thumb Throttle And Grips |
| 5404 | Front Tube Set |
| 5413 | Front Fender Set |
| 5405 | Deck Incl. Head & Neck Tube Welding With Head Badge |
| 5406 | Rear Fork Set |
| 5407 | Griptape |
| 5275 | Front Wheel Incl. Screw & Nut |
| 5276 | Front Cover Incl. Screw |
| 5277 | Rear Brake Set With Reflector Sticker |
| 5414 | Lower Clamp |
| 5408 | EU Charger 24V |
| 5409 | UK Charger 24V |
| 5299 | US Charger 24V |
| 5300 | AU Charger 24V |
| 5415 | Clamp For Handlebar Incl. Screw |
| 5416 | Fork Set |
| 5400 | Battery + Motor + Controller Set Incl. Hall Sensor |
| 5410 | Kickstand Only /10 Sets Incl. |
| 5417 | Charger Cover W/Holder & Screw /50set Incl. |
| 5285 | Deck Screw /200pcs Incl. |
| 5294 | Motor Nut Protective Cover /100pcs Incl. |
| 5295 | Front Wheel Axle Screw Set /200pcs Incl. |
| 5296 | Hall Sensor Screw /50pcs Incl. |
| 5282 | Grips |
| 5288 | Screws For Kickstand /50pcs Incl. |
| 5289 | Bolt & Spring For Fender Brake /50 Sets Incl. |
| 5401 | Motor Tire Set |
| 5402 | Throttle |

| Article No. | Article |
|-------------|---------------------------------|
| 5403 | Throttle Cable Adapter |
| 5418 | Deck Protective Cover |
| Sbox310 | Color Box For Sparrow XL |
| 5291 | Bluetooth (For Diagonise Tool)“ |
| 5293 | Wheel Bearings /40pcs Incl. |



MICRO
SPARROW
EM0017

MICRO SPARROW EM0017

PARTS

| Article No. | Article |
|-------------|---------------------------------------|
| 5270 | Front Tube |
| 5271 | Front Fender Set |
| 5272 | Deck Set |
| 5273 | Rear Fork |
| 5274 | Griptape |
| 5275 | Front Wheel |
| 5276 | Front Deck Cover |
| 5277 | Rear Brake Complete |
| 5278 | Lower Clamp |
| 5279 | Stem With Screws |
| 5280 | Fork Complete |
| 5281 | Battery & Motor Set Incl. Hall Sensor |
| 5282 | Grip |
| 5290 | Handlebar Set |
| 5284 | Kickstand With Screws |
| 5285 | Deck Screws Set |
| 5287 | Front Wheel Axle |
| 5288 | Screws Kickstand |
| 5289 | Bolt And Spring For Brake |
| 5297 | EU Charger |
| 5298 | UK Charger |
| 5299 | US Charger |
| 5300 | AU Charger |
| 5292 | Charger Cover |
| 5293 | Wheel Bearings |
| 5294 | Motor Nut Protective Cover |
| 5295 | Front Wheel Axle Screw Set |
| 5296 | Hall Sensor Screw |



MICRO
SPARROW
EM0017